

PS SERIES

Extra heavy duty high flow couplings

INTRODUCTION

Holmbury's PS Series extra heavy duty screw couplings have been developed to withstand high flows, intense pressure pulses and vibration. At an independent test laboratory they have exceeded 3,000,000 impulse cycles whilst being subjected to heavy vibration in the horizontal and vertical planes.

CONSTRUCTION

- Carbon steel with zinc nickel plating (1200 hours with no red rust in salt spray tests)
- Fitted with Viton seals

FEATURES

- Screw connect design eliminates brinelling
- Once fully connected all internal components are held rigid, significantly reducing the risk of material fatigue
- Can accommodate flow rates up to 1000 L/Min with minimal pressure drop
- Attachment changeover time significantly quicker than with fixed pipes or valves
- Can be connected with up to 50 bar residual pressure in the hydraulic circuit
- Bidirectional flow

ACCESSORIES

- Dust Caps and Plugs are available for the PS Series



SPECIFICATIONS

- Operating temperatures (With Viton seals): -20°C (-4°F) to 200°C (392°F)

APPLICATIONS

- High reach demolition machines
- Large excavators over 20 tonnes

ORDER CODES

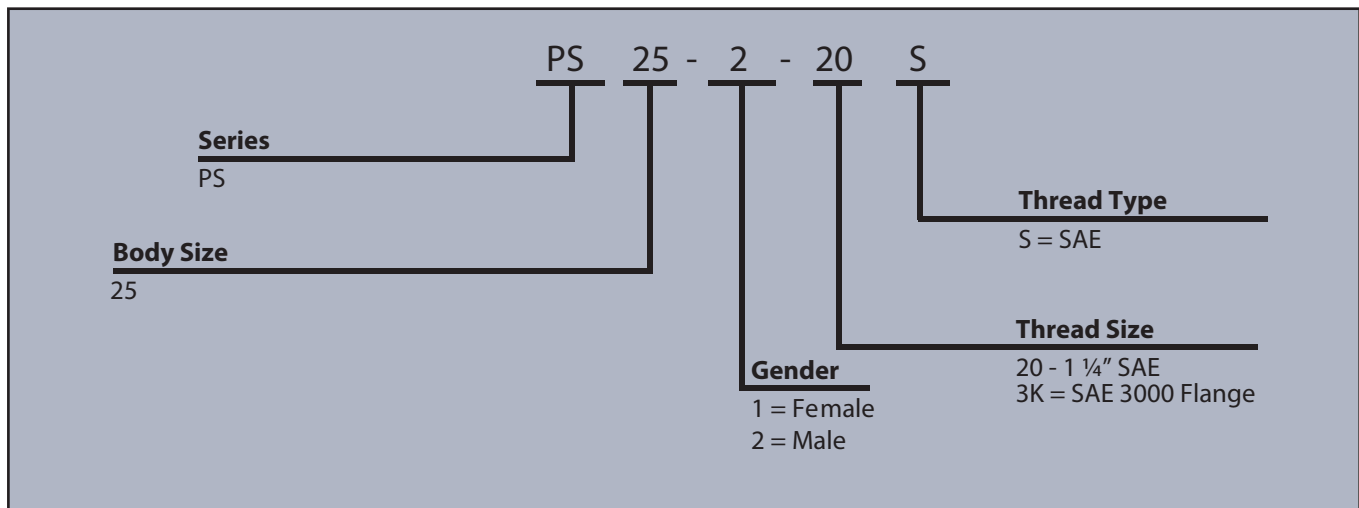

DRAWING

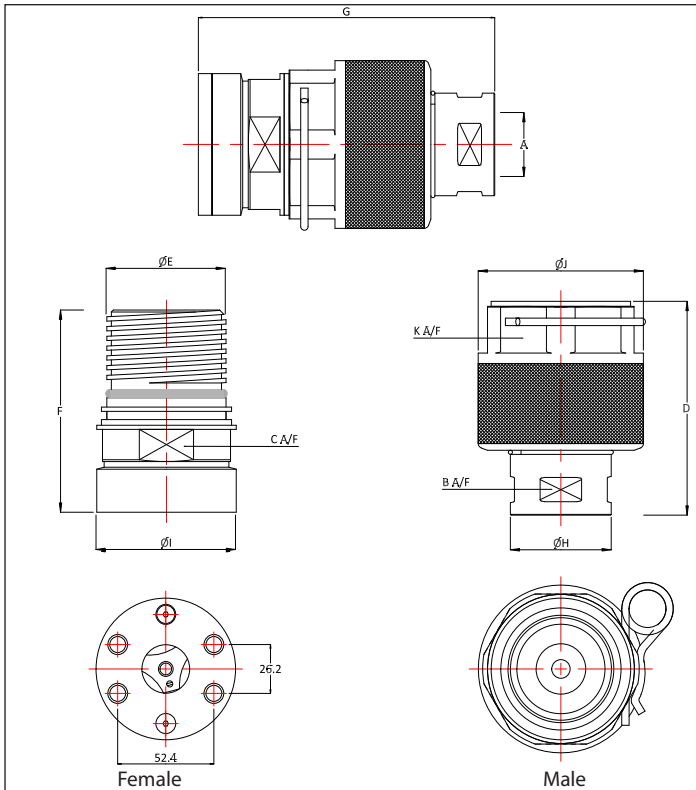

PRESSURE DROP CHARACTERISTICS

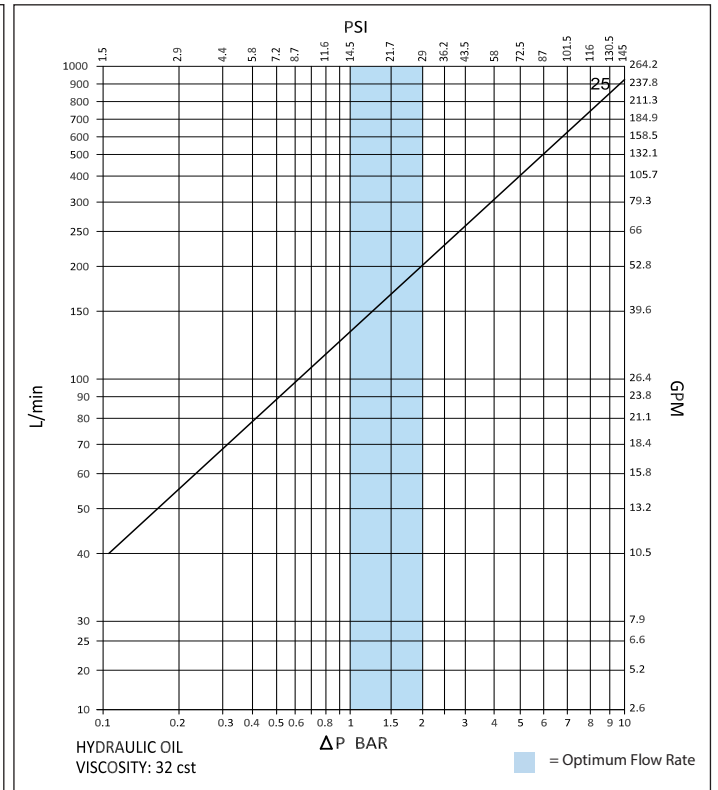

SCREW CONNECT COUPLINGS

DIMENSIONS

Size	Thread Size (A)	B	C	K	D	ØE	F	G	ØH	ØI	ØJ	Maximum Working Pressure	Burst Pressure (Coupled)	Burst Pressure (Male)	Burst Pressure (Female)
		Dimensions in mm										Bar			
		Dimensions in Inches										Psi			
PS 25	1-1/4"	50.0	70.0	80.0	111.5	65.0	108.5	160.0	55.0	76.0	90.0	500	2000	2000	2000
		2.0	2.8	3.1	4.4	2.6	4.3	6.3	2.2	3.0	3.5	7250	29000	29000	29000

PSI= Bar x14.5 Inches= mm/25.4

