

# LC SERIES

## Heavy duty screw connect couplers

### INTRODUCTION

Holmbury's LC Series heavy duty, screw connect couplers are an ideal solution for hydraulic circuits where high pressure or pressure impulses are present. They are designed primarily for heavy duty applications. An API 16D certified version of LC Series is available in sizes 19 | 25 | 32 which are Lloyds certified in accordance with API 16D and the EUB Directive #36 and suitable for the Oil & Gas industries, for use in blow out preventer (BOP) applications.

### CONSTRUCTION

- Carbon steel with trivalent plating
- Cast steel heavy duty sleeve
- Fitted with Nitrile seals

### FEATURES

- Inspection hole enables check of complete connection between both halves
- Screw connect design eliminates brinelling
- Hard wearing heavy duty sleeve
- Bidirectional flow

### ACCESSORIES

- Dust caps and Plugs are available for the LC Series



### SPECIFICATIONS

- Operating temperatures (With Nitrile seals): -40°C (-40°F) to 106°C (223°F)
- API 16D certified and Lloyds approved for BOP applications in sizes 19 to 32

### APPLICATIONS

- Heavy duty applications
- High pressure pulse applications

### ORDER CODES

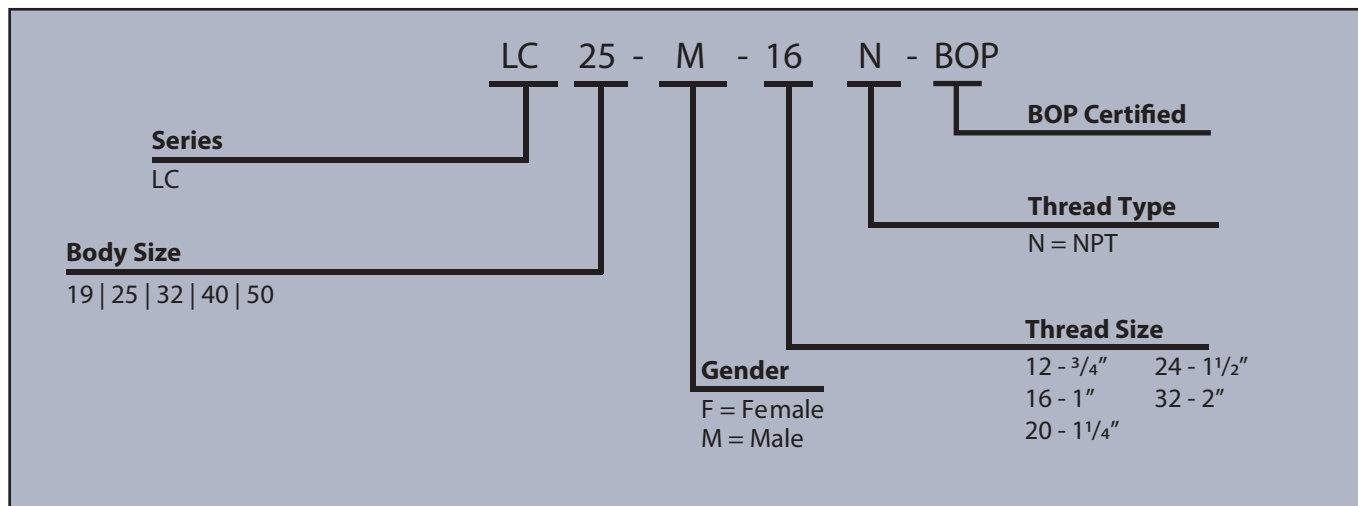

## DRAWING

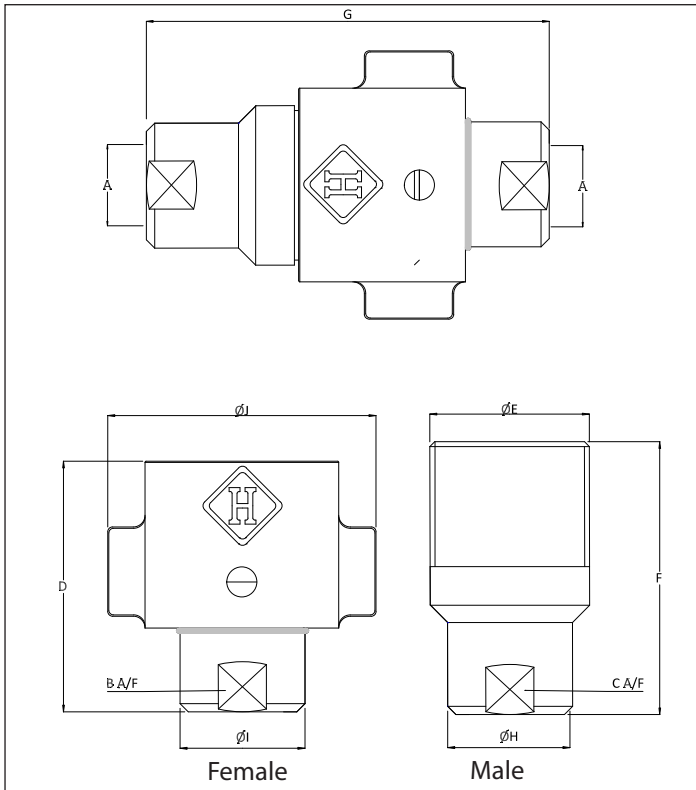

## PRESSURE DROP CHARACTERISTICS

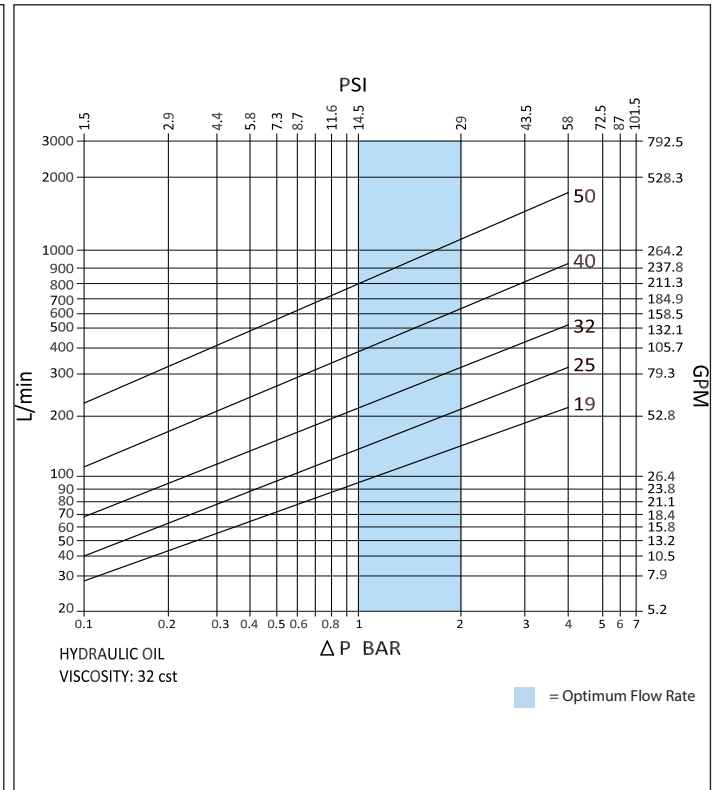

SCREW CONNECT COUPLERS

## DIMENSIONS

Size	Thread Size (A)	Dimensions in mm							Bar			
		D	ØE	F	G	ØH	ØI	ØJ	Maximum Working Pressure	Burst Pressure (Coupled)	Burst Pressure (Male)	Burst Pressure (Female)
LC 19	3/4"	70.0	44.5	83.0	124.0	32.0	32.0	82.5	345	1380	1380	1380
		2.8	1.8	3.3	4.9	1.3	1.3	3.2	5000	20010	20010	20010
LC 25	1"	87.0	57.0	106.0	153.5	41.0	41.0	102.0	345	1380	1380	1380
		3.4	2.2	4.2	6.0	1.6	1.6	4.0	5000	20010	20010	20010
LC 32	1 1/4"	109.0	66.5	136.0	198.0	50.0	50.0	119.0	345	1050	1050	1050
		4.3	2.6	5.4	7.8	2.0	2.0	4.7	5000	15225	15225	15225
LC 40	1 1/2"	128.5	82.5	150.0	220.0	58.0	58.0	138.0	345	1050	1050	1050
		5.1	3.2	5.9	8.7	2.3	2.3	5.4	5000	15225	15225	15225
LC 50	2"	152.0	101.5	179.0	255.0	75.0	75.0	170.0	345	1050	1050	1050
		6.0	4.0	7.0	10.0	3.0	3.0	6.7	5000	15225	15225	15225

PSI= Bar x14.5 Inches= mm/25.4

